

# Marinefloor

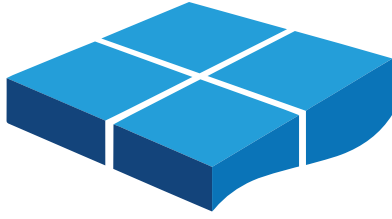

p o n t o n m o d u l a i r e



## 2024 CATALOG

### Main elements

#### Cube Eco-System MARINEFLOOR



Size: L x l x H: 50 x 50 x 40 cm - Weight: 6,50 Kg - Buoyancy: 91,5 Kg  
Resistance of assembling rings: 2.000 Kg - Patented male/female interlocking system Shockproof  
PEHD (High Density Polyethylene) - Antistatic, low flammability  
Standard colours: beige and light grey - Other colours on demand (1 000 pieces minimum). Anti-skid structure - Based on 4 plots (increase stability, reduce current pressure) - ECO Patented

#### Centre Pins



Attaches by interlocking, is locked by the stainless steel centre pins' key  
Size:  $\varnothing$  x  $\varnothing$  x H: 18 x 4,6 x 24 cm - Weight: 0,68 Kg  
Shockproof, PEHD, only used to connect 4 cubes together  
Standard colours: beige and light grey - Other colours on demand (1 000 pieces minimum)

#### Bolt, Nuts and Ring



Fixed on the structure perimeter with the use of a special key  
Size: 4,3 x 14,5 cm  
Shockproof, HDPE  
Colour: white

#### Locking Stainless Steel Key



Essential key for assembling Marinefloor structures  
It is used to lock the center pins, remove them and many other common applications in assembly.  
Marine Quality Stainless Steel - Weight : 2,5 Kg

# Boatfloor and Jetfloor elements

## Entrance Ramp – 1 piece/dock



Size: L x l x H: 150 x 75 x 40/20 cm

**Standard version : for jet-skis and sizes S & M BoatFloor (<2.5m wide)**

**Reinforced version : for L size BoatFloor and Aluminium ribs**

Standard Weight: 18 Kg - Reinforced weight : 22 Kg

Standard colour: light grey - Reinforced color : dark grey

Shockproof, PEHD-RT (High Density Polyethylene)

Need to be completed by 2 side cushions and 2 central cushions.

## Left Slider

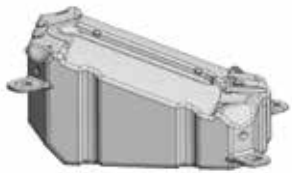

Size: L x l x H: 75 x 50 x 40/20 cm - Weight: 7,5 Kg

Shockproof, PEHD-SF (High Density Polyethylene)

Standard colour : light grey

L marking

Need to be completed by 1 side cushion

## Right Slider

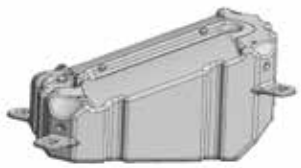

Size: L x l x H: 75 x 50 x 40/20 cm - Weight: 7,5 Kg

Shockproof, PEHD-SF (High Density Polyethylene)

Standard colour : light grey

R marking

Need to be completed by 1 side cushion

## Slider Stop – 1 piece/dock

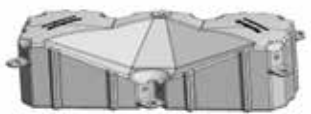

Stop the boat or jet-ski race to protect the engine + mooring

Size(L x l x H): 150 x 50 x 40/20 cm - Weight: 14 kg

Shockproof, PEHD-RT (High Density Polyethylene)

Standard colour: light grey

## Central Cushion



Size: L x l x H: 23x 12 x 6 cm - Weight: 0,4 Kg

Standard colour : beige

PEHD-SF (High Density Polyethylene)

1 piece clips to the sliders connexion

Easy to change

## Side Cushion



Size: L x l x H: 45 x 12 x 16 cm - Weight: 0,55 Kg

Standard colour : beige

PEHD-SF (High Density Polyethylene)

1 piece clips to each slider

Easy to change

# Protecting accessories

## Fender



Absorb the docking shocks, does not scratch boat hulls

Size (D x H): 33 x 27 cm / Weight: 0,7 Kg

LDPE shockproof

Standard colour: black or orange

Other colours on demand (minimum 100 pieces)

## Heavy Fender

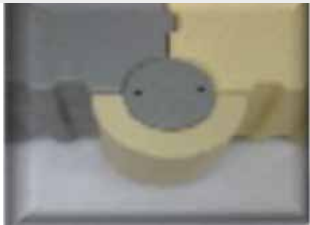

Absorb the docking shocks, does not scratch boat hulls

Can be used to fix handrails (except for Public application)

Size (Ø x H) : 33 x 27 cm / Weight : 1,40 Kg

LDPE shockproof

Standard colour: egg shell

Other colours on demand (100 pieces minimum)

## Fender for Swimming Pontoon



Absorb the docking shocks, does not scratch boat hulls

Displays the rules to follow as symbols.

Size (D x H): 33 x 27 cm / Weight: 0,7 Kg

LDPE shockproof

Standard colour: orange

Other colours on demand (100 pieces minimum)

# Mooring accessories

## Stainless Fixation Plate for Dock



To fix the dock to a traditional floating pontoon. The holes allow it to be adapted to most of conventional pontoons, by attaching themselves in the groove reserved for the mooring cleats. The fixing bolts must be provided by the harbor master's office (identical to the cleats-depends on each pontoon manufacturer).

Size: Plate (L x l x H) : 330x200x6 mm

Pipe (Ø x Ep) : 42x2 mm - Length: 1m

## Mooring ring



Is necessarily fixed on 4 cubes as a traditional pins  
Mounted into a center pin

Weight: 2 kg

Tensile strength : 2.000 Kg

Marine quality stainless steel

## Heavy Mooring Bollard



Use for heavy boats (several tons)

Mounted on 4 center pins

Tensile strength : 12.000 Kg

Size: L x l x H x ø: 76 x 76 x 27 x 10 cm

Weight: 12 Kg

Marine quality stainless steel

## Mooring Bar PVC 20mm



Used for connecting a chain to a cube structure (cushioning shocks)  
Fixing with bolt and nut

Can be applied for mooring on dangling

Size (L x l x H) : 590 x 90 x 20 mm / Weight : 1.9kg

20mm PVC pressed - Color : dark grey

## Lifting Sling



Used to fix swimming pontoon (in the center, 4 units), can be applied to connect a chain on a cube structure (cushioned shocks)

Tensile strength : 2 T

Dimensions : 117cm x 2 cm – Polyamide 2mm



# Security accessories

## Stainless Handrail



Fixed 50 cm back from the edge like traditional center pin  
Mounted on 1 center pin - Weight : 4,00 kg  
Dimensions : Ø x H : 4,2 x 110 cm - Marine quality stainless steel  
Distance between each rail from 2 m to 3 m – linked by 16 mm red/orange ropes as handrail (sold separately)

## Stainless U Handrail



Fixed 50 cm back from the edge like traditional center pin Mounted on 2 center pins - Weight : 8,00 kg  
Dimensions : Ø x H : 4,2 x 110 cm - Marine quality stainless steel Mainly used for boarding passengers

## Stainless Steel Ladder



Equipped of 3 submerged rungs  
Mounted on 4 centre pins  
Adaptable on every platform's side  
Weight : 16,20 kg

## Life Buoy + Box + Lifeline



Storage box with 1 life buoy Ø73 cm , 1 buoyant lifebuoy line 30m. Can be fixed on a wall or a handrail.  
This box has a window to check the presence of the buoy

## Safety Net 50 - 1mx10m



Applied and fixed on handrails (rope 16mm)  
Square 50 x 50 mm – safety net rope around the perimeter  
Length : 1m x 10m

## Red Ropes for handrail



Polyamid rope 3 strands  $\varnothing$ 16mm  
Color: Red  
Coil of 200 m without reel  
Sales unit in meters: 20/50/70/100/120/150/170/200

## Anchoring accessories

### Screw-in anchors 1m50 galvanised -2 plates



2 plates galvanized – dimensions 1.5m x30mm 2 plates 250x10  
Installation in loose soil (sand, mud, loose soil)  
Tensile strenght 2 T (depending of the ground)  
mechanical or manual installation

### Screw-in anchors 1m25 galvanised -1 plate



1 plate galvanized – dimensions 1.25m x30mm 1 plate 250x10  
Installation in loose soil (sand, mud, loose soil)  
Tensile strenght 1 T (depending of the ground)  
mechanical or manual installation

## Galvanized chain 14mm



Galvanized Marine Quality  
Tensile strength 25 T  
Weight: 4.44kg / ml

## Stamped Bow Shackle 14mm - Galvanized



Galvanized Marine Quality  
connection on folded chain

## Anchor FOB HP - 10 Kg



Anchor for mooring on sandy or muddy bottoms.  
Approved anchor with high holding power by Bureau Véritas.  
French manufacturing in galvanized steel. Mobile rod.  
Weight: 10 kg

## Anchor FOB HP - 8 Kg



Anchor for mooring on sandy or muddy bottoms.  
Approved anchor with high holding power by Bureau Véritas.  
French manufacturing in galvanized steel. Mobile rod.  
Weight: 8 kg

## White Rope 16mm



Polyamid rope 3-strand White 16mm  
Resistance 5200 Kg  
Reel of 200 m  
Sales units : 25m, 50m, 75m, 100m, 125m, 150m, 175m et 200m

# MARINEFLOOR IS ALSO ...

## Customizing cubes with your image/logo



Possibility to custom your production of cubes: insert your logo or/and pick a color from our range (1000 cubes min.).

*Available on quote only*

## Custom application



Whatever you would like to float, do not hesitate to contact our team to discuss your project.

We have used our system for a wide range of applications and most of the time it was original. Based on our experience, we would realise with you your craziest projects!

## Engineering - Installation - Event Rentals - Seasonal Rentals



The strength of our team is to fit your requirements.

Need help for a practical reflection of your project?

Need a fitting service?

Need our products for a short period of time, independently?

Need an all inclusive service for an event?

We have a solution to your needs!

Contact us!